

# Balfour Beatty

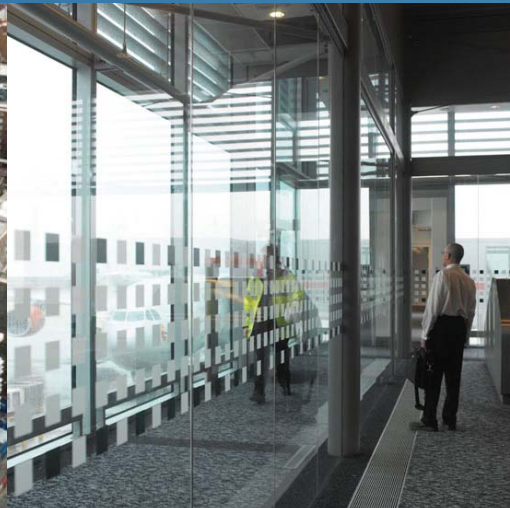

## 2005 Interims

17 August 2005



# Anthony Rabin

**Balfour Beatty**

# Headline numbers

	First half 2004	Pro forma first half 2004	First half 2005	
Turnover (revenue)	£2,026m	£2,026m	£2,308m	+14%
Pre-tax profit* continuing operations	£53m	£44m	£52m	+18%
Adjusted eps*	10.4p	10.1p	9.3p	-9%

\* Before exceptional items, and in the case of eps, premium on buy-back of preference shares

# Headline numbers

---

	First half 2004	First half 2005	
Interim dividend	2.85p	3.5p	+23%
Net cash (excluding 100% PFI)	£121m	£299m	
Order book	£6.5bn	£7.4bn	+14%

# Performance by sector

---

Full year 2004	£m		First half 2004	First half 2005
<b>34</b>	<b>Building, Building Management and Services</b>		<b>14</b>	<b>8</b>

# Building, Building Management and Services

---

Full year 2004	£m	First half 2004	First half 2005
34		14	8

- Steady underlying performance
- Mansell performs particularly well
- Some short-term contract issues in Construction
- Heery performance improves
- **Significantly stronger performance expected in 2<sup>nd</sup> half**

# Performance by sector

---

Full year 2004	£m	First half 2004	First half 2005
34	Building, Building Management and Services	14	8
16	<b>Civil and Specialist Engineering and Services</b>	<b>8</b>	<b>17</b>

# Civil and Specialist Engineering and Services

Full year 2004	£m	First half 2004	First half 2005
(3)	Civil and specialist engineering	(1)	10
19	Services	9	7
16		8	17

- Steady performance overall
- Significant improvement in US civils performance
- Utilities gearing up for major new long-term contracts
- Good progress expected to be maintained in 2<sup>nd</sup> half



# Performance by sector

---

Full year 2004	£m	First half 2004	First half 2005
34	Building, Building Management and Services	14	8
16	Civil and Specialist Engineering and Services	8	17
<b>44</b>	<b>Rail Engineering and Services</b>	<b>23</b>	<b>20</b>

# Rail Engineering and Services

Full year 2004	£m		First half 2004	First half 2005
50	UK businesses		19	26
(6)	Overseas businesses		4	(6)
44			23	20

- Steady UK performance - renewals settlements
- German market remains depressed
- Write-down of one US rail signalling contract
- 2<sup>nd</sup> half performance expected to remain satisfactory

# Performance by sector

---

Full year 2004†	£m	First half 2004†	First half 2005
34	Building, Building Management and Services	14	8
16	Civil and Specialist Engineering and Services	8	17
44	Rail Engineering and Services	23	20
<b>17</b>	<b>Investments and Developments</b>	<b>7</b>	<b>8</b>

† Pro forma

# Investments and Developments

Full year 2004	£m	First half 2004			First half 2005		
		PFI JVs & Assocs	Barking	Total	PFI JVs & Assocs	Barking	Total
26	Share of results of JVs & associates	7	3	10	8	4	12
(9)	Group operating profit*			(3)			(4)
<b>17</b>	<b>I &amp; D operating profit</b>			<b>7</b>			<b>8</b>
16	<i>Group net finance income</i>			8			9
9	<i>Subordinated debt interest income</i>			3			3
42	<i>I &amp; D net result</i>			18			20

\* Including Property and excluding exceptional items

# Investments and Developments

---

- UCLH 1<sup>st</sup> phase and M77 handed over on-time
- Financial close on North Lanarkshire and Bassetlaw schools
- Metronet performance satisfactory
- Pre-qualification and bidding opportunities strong
- Satisfactory performance expected for full year

# Performance by sector

Full year 2004†	£m	First half 2004†	First half 2005
34	Building, Building Management and Services	14	8
16	Civil and Specialist Engineering and Services	8	17
44	Rail Engineering and Services	23	20
17	Investments and Developments	7	8
(17)	Corporate costs	(10)	(10)
94	Profit from operations*	42	43
13	Net finance income*	2	9
107	Pre-tax profit – continuing operations*	44	52

\* Before exceptional items

† Pro forma

# Operating profit v operating cash flow

£m	First half 2004*	First half 2005*
Group operating profit	31	24
Trading profit from discontinued operations	7	-
Depreciation	20	20
Other items	1	1
Working capital decrease	8	39
Cash generated from operations	67	84

\* Treating PFI subsidiaries as associates / joint ventures

# Balance sheet cash movement

£m	First half 2004*	First half 2005*
Opening net cash	127	311
Cash generated from operations	67	84
Dividends from JVs and associates	8	9
Capital expenditure and financial investment	(17)	(33)
Acquisitions and disposals	(15)	(6)
Buy-back of preference shares	(18)	(9)
Dividends, interest and tax paid	(34)	(55)
PFI / PPP borrowings at acquisition	-	-
Other items	3	(2)
Closing net (debt) / cash	121†	299

\* Treating PFI subsidiaries as associates / joint ventures

† Before £218m net cash from sale of Andover



# Exceptional items

---

£m

---

## Profit from operations:

TXU distributions to Barking Power (net of tax)	24
---	----

## Finance costs:

Premium on buy-back of preference shares	(3)
--	-----

Premium on repayment of US\$ term loan	(6)
--	-----

Tax on exceptional finance costs	2
----------------------------------	---

Net exceptional post-tax profit	<hr/> 17
---------------------------------	----------

# Pension charges under IAS 19

Full year 2004	£m	First half 2004	First half 2005
50	Current service cost	24	24
(5)	Net finance income	(2)	(2)
2	Defined contribution schemes	1	1
47		23	23
(8)	Exceptional settlement gain	-	-
39		23	23

# Group balance sheet

£m	Dec 2004	Pro forma Dec 2004	June 2005
Goodwill*	310	305	307
Net cash	311	311	299
Preference shares – liability	-	(103)	(99)
PFI / PPP subsidiaries	32	63	72
Non-current assets + working capital	276	307	319
Non-recourse net debt	(244)	(244)	(247)
Other assets / liabilities	(351)	(349)	(302)
Shareholders' funds	302	227	277

\* Includes share of joint ventures and associates

# Summary

---

- No impact from IFRS on business operations, strategy or cash
- Continuing growth in profits
- Strong cash flow
- Strong cash position to support future growth

# Ian Tyler

**Balfour Beatty**

# First half 2005

---

- Strong cash generation
- Increased order book
- Turnaround in US civils
- Growth in PFI portfolio
- Satisfactory settlement of legacy rail issues

Dividend rebased

# Today's agenda

---

- Mansell – an established leader in growing markets
- Balfour Beatty Utilities – a new business to exploit market change
- Heery – solid positions and future growth potential
- Texas Highways – a growing business with future PFI potential

# Mansell

---

- Substantial portfolio of long-term frameworks
- Social housing





# Mansell

---

- Top 10 frameworks have £600m potential
- Good spread of customer types
  - British Telecom
  - BAA
  - Department of Work and Pensions
  - Metropolitan Housing Association
  - University of Reading
  - MoD

# BAA



**Mansell**  
Airports

# Defence Estates



# Social housing – key trends

---

- £22bn government spend committed – private sector to match
- All housing to “decent” standards by 2010
- Project size increasing in value and duration
- Potential for new procurement methods

# Market trends – social housing

---

	Estimated Annual Value £m
• Morgan Sindall (Lovell Partnerships)	420
• <b>Mansell</b>	<b>200</b>
• Kier	185
• ROK	180
• Wates	175
• Willmott Dixon	160
• Keepmoat	135

*Source: Contract Journal, July 2005*

# UNITE



# Mansell

---

- Excellent spread of blue chip customers
- Dedicated skills aligned to market sectors
- Comprehensive regional network
- High customer satisfaction ratings

# Balfour Beatty Utilities

---

- Acquisition of John Kennedy and Kentons (£70m)
- Merged and reorganised in 2002





# Why invest in utilities?

---

- Growth and change from regulatory reviews
- Continued trend to outsourced services
- Within Balfour Beatty's competence footprint

# The markets

---

- 78% of water network yet to be upgraded / replaced
- 50% of gas network yet to be upgraded / replaced
- 77% of volumes now under partnering / alliance contracts

# Forward order book

---

Order book: c.£1bn

---

**including:** Greater Manchester NGT Alliance  
United Utilities Integrated Services  
Anglian and Severn Trent Water  
South West and Yorkshire Water

# Balfour Beatty Utilities

---

## Market shares

- Clean water – operations 18%
- Clean water – capital 19%
- Gas mains replacement 15%
- Wastewater 6%

# The current position

---

- Order book secured to 2010
- Mobilisation in progress
- Efficiencies key to maximising margin levels

# Heery International

---

## *Capabilities*

- Architecture
- Interior design
- Engineering
- Facilities planning and design
- Construction management
- Programme management



# K-12 education

---

- Market volumes on long-term upward trend
- Market leader with a substantial track record
  - 160 school districts
  - \$20 billion managed value
- Long-term relationships with key customers



# Federal government

---

- Major Washington presence
- Leading supplier to the GSA
  - eg Department of Transportation
  - National Archives Building
  - Patent and Trademark Office
- Well positioned for high-growth security market





# Other growth business

---

- Healthcare
  - Veterans hospitals and clinics
  - HUD funded critical access hospitals
- Higher education
  - Public and community college upgrade
  - Site master planning
- Justice
  - Federal and county courthouse programme

# Heery

---

- \$55m profits, \$60m cash
- Recent acquisitions further strengthen business
- Positive market fundamentals

# Balfour Beatty Construction Inc

---

- Three regional businesses
  - Texas
  - California
  - Pennsylvania / Ohio

# The Federal Transport budget

---

- \$286bn federal funding guaranteed 2005-2009
- Up 38% on previous budget

## Top spending states 2005/09

---

	\$bn	
California	17.2	+34%
Texas	14.5	+37%
Florida	8.7	+33%
New York	8.4	+19%
Pennsylvania	8.2	+19%
Ohio	6.6	+36%

# Texas Highways Division

---

- Set up in 1995
- Experienced management team
- 40+ road projects – worth £1bn over 10 years
- Consistently profitable
- SH 130 going well
- PFI market in development

# Texas Highways Division

---

Turnover (\$ million)

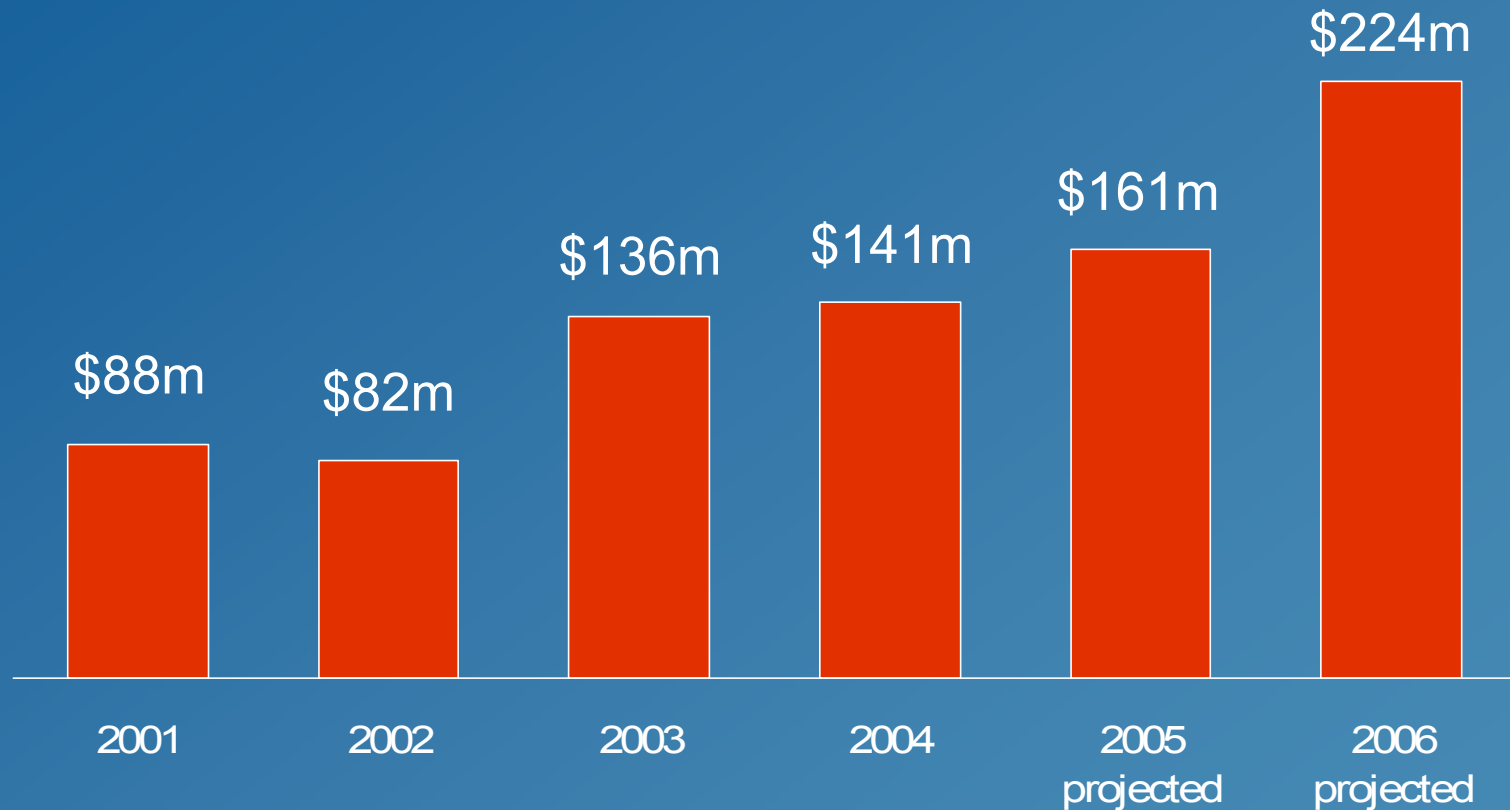

**Balfour Beatty**

**Balfour Beatty**

# Outlook

---

- Good trading prospects
- Substantial net cash
- Normal seasonal pattern resumed
- Good progress in year as a whole



**Balfour Beatty**

**Balfour Beatty**